

# WLIGHT LED

**SEMAFORO ROSSO/VERDE**  
**RED/GREEN TRAFFIC LIGHT**  
**FEU DE CIRCULATION ROUGE/VERT**  
**SEMÁFORO ROJO/VERDE**  
**ROT/GRÜNE AMPEL**

IT

EN

FR

ES

DE

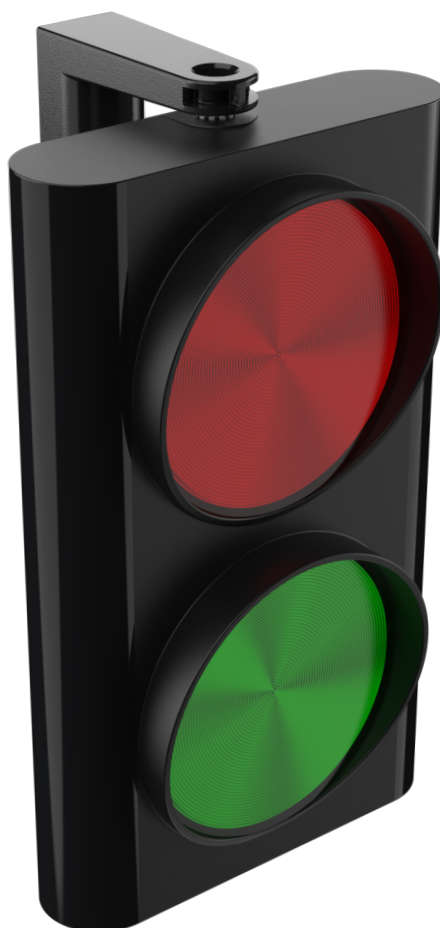
**SEA S.p.A.**

Zona Industriale Sant'Atto - 64100 - Teramo - ITALY

Phone: +39 (0) 861 588 341 r.a.

<http://www.seateam.com>



## WARNING



This instruction manual contains important information regarding safety: read all instructions carefully before proceeding with installation. The SEA company assumes no responsibility for damage due to improper, erroneous and unreasonable use of the product. Keep this manual carefully for future use as well.

## DESTINATIONS AND LIMITS OF USE

WLIGHT LED was designed for private use, management of parking lots, alternating one-way streets of condominium areas. WLIGHT LED is NOT a traffic light for public use, roads, highways etc. the SEA company will be relieved of any responsibility in the event of improper use and installation.

## TECHNICAL FEATURES

| TECHNICAL DATA              | 40 LED board      |
|-----------------------------|-------------------|
| Power supply                | 24 V ac/dc        |
| Nominal current consumption | 0,13 A            |
| Power                       | 1,50 W            |
| Brightness**                | 120 lx<br>(±10lx) |
| Working temperatures        | -20 / +55 °C      |
| IP                          | 66                |

\*\*The brightness is expressed in Lux [lx], and is relative to the light source

## DIMENSIONS FOR WALL FIXING

### WITH ADJUSTABLE BRACKET

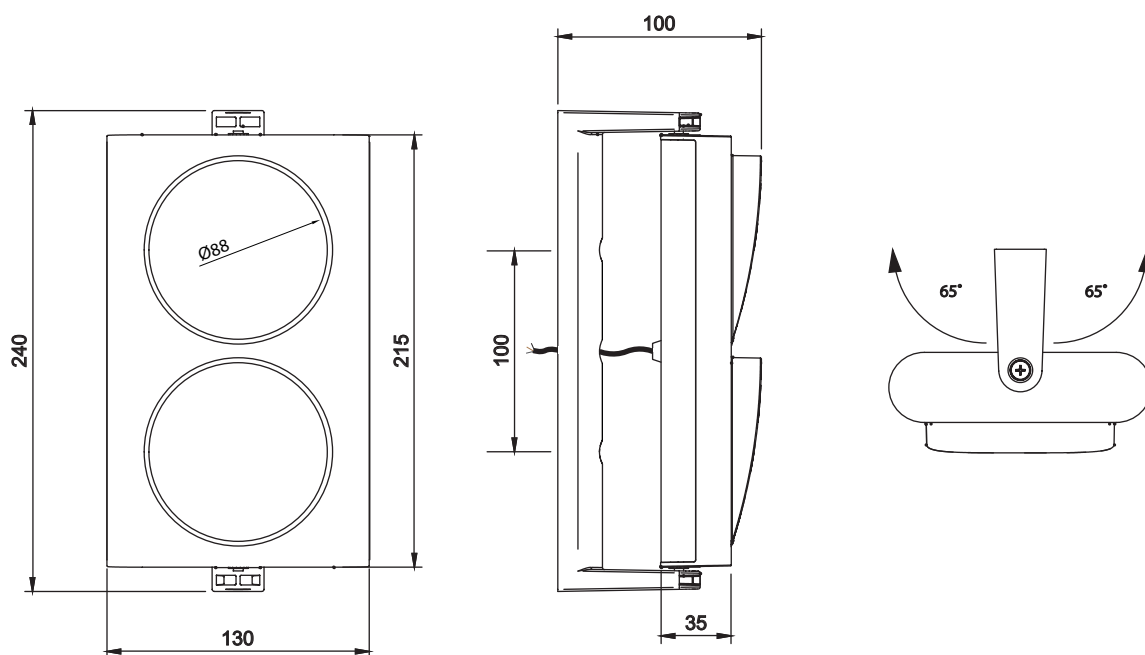

EN

## WALL FIXING

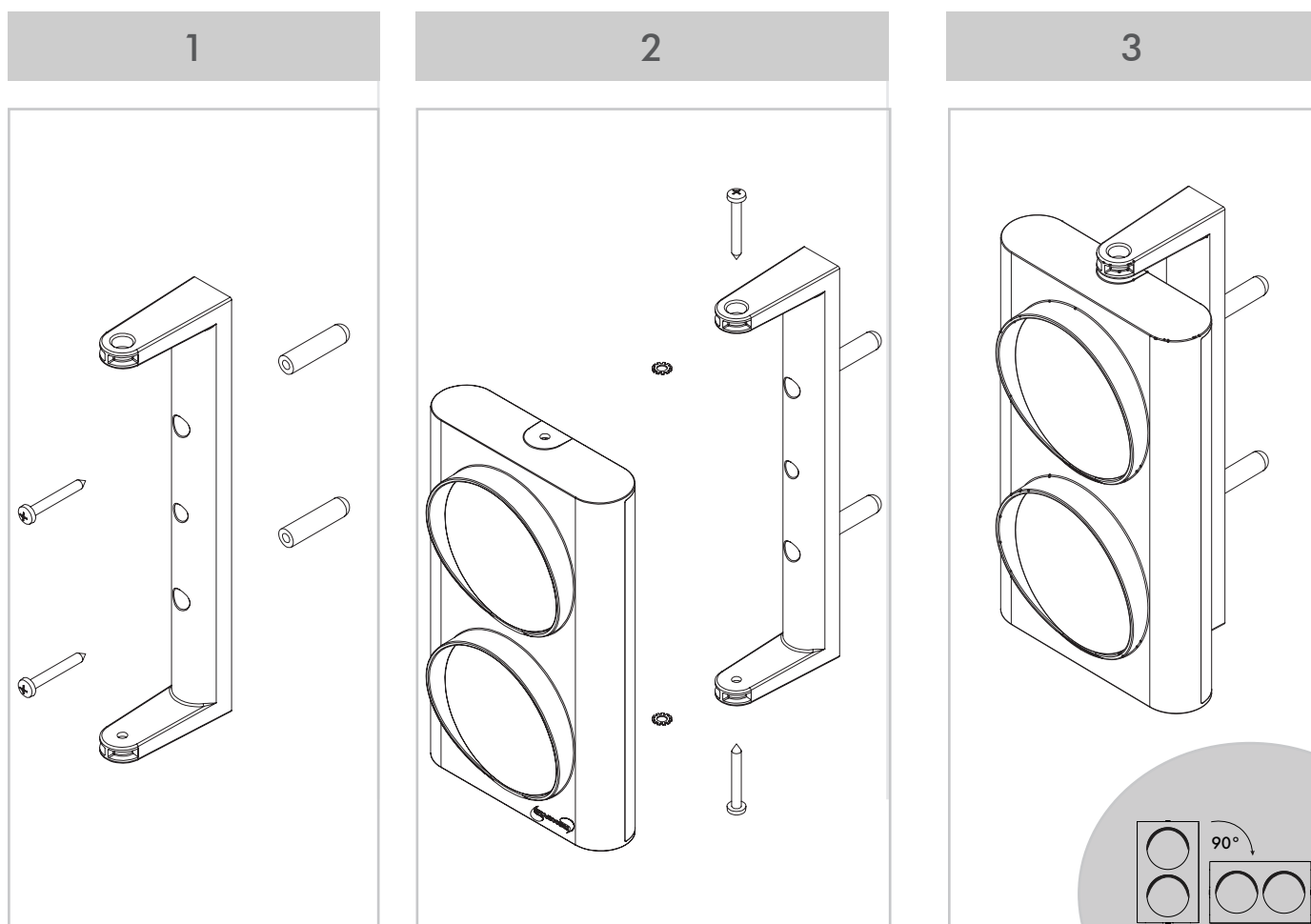

## DIMENSIONS FOR WALL FIXING

### WITHOUT ADJUSTABLE BRACKET

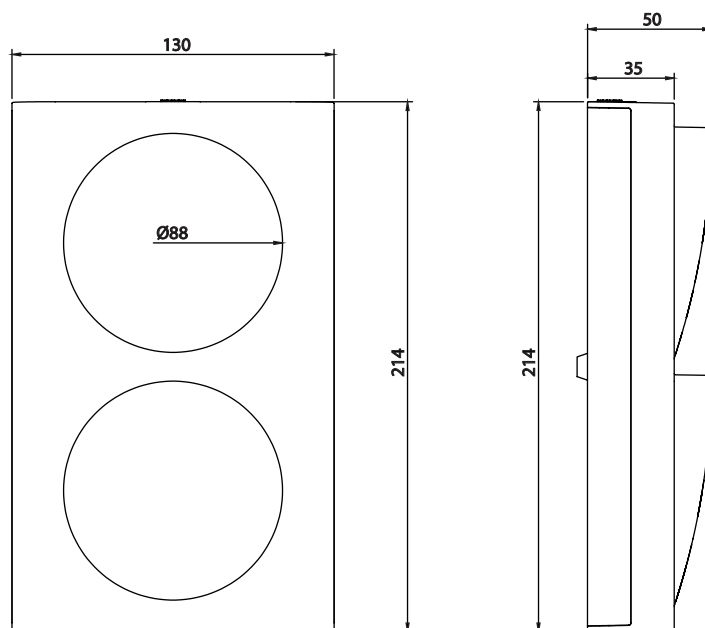

## WALL FIXING

1

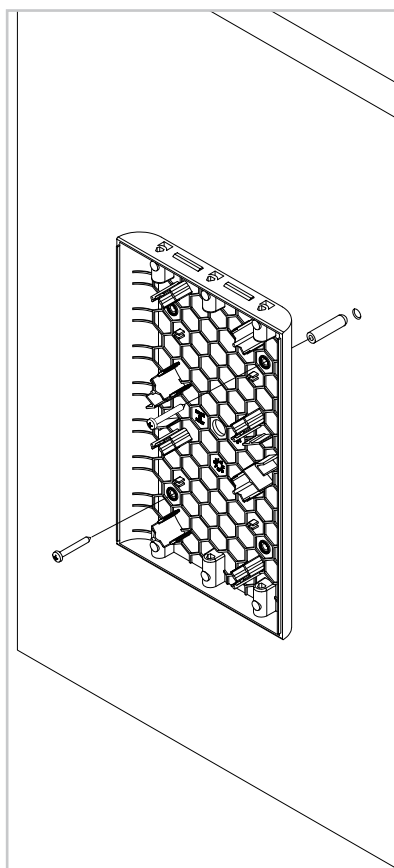

2

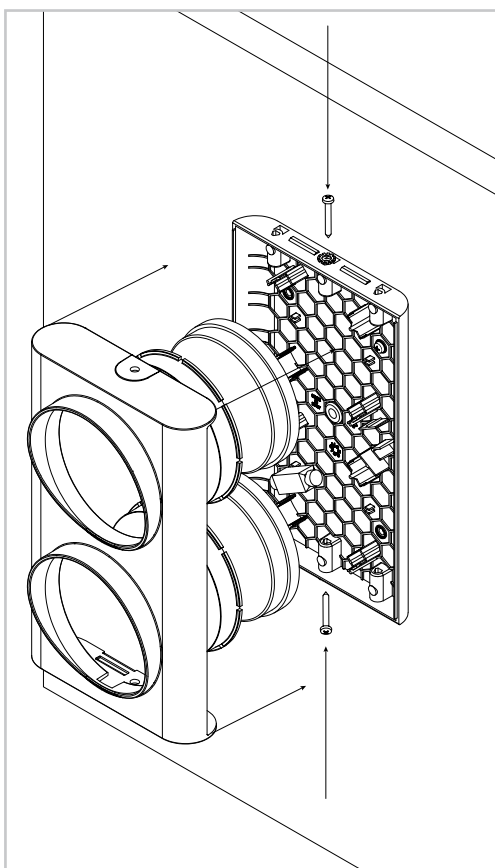

3

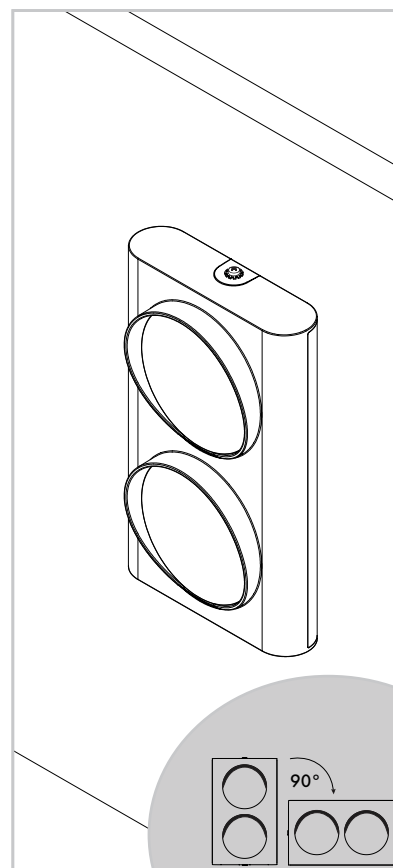

## DIMENSIONS AND OVERALL FOOTPRINT FOR INSTALLATION ON POLE

### TRAFFIC LIGHT WITH POLE BRACKET

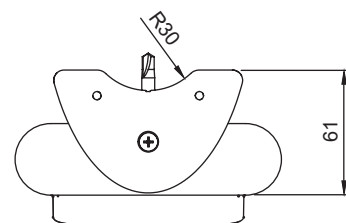
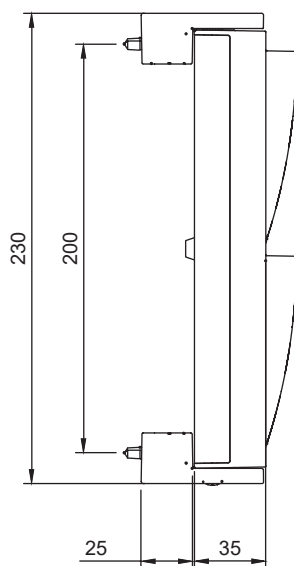
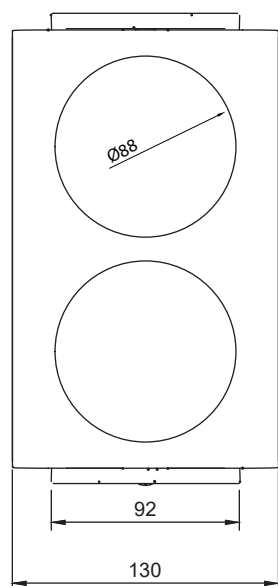

EN

## FIXING TO POLE

1

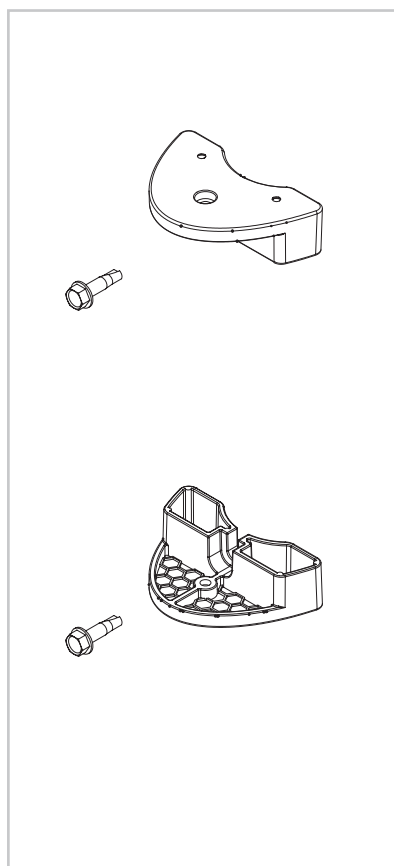

2

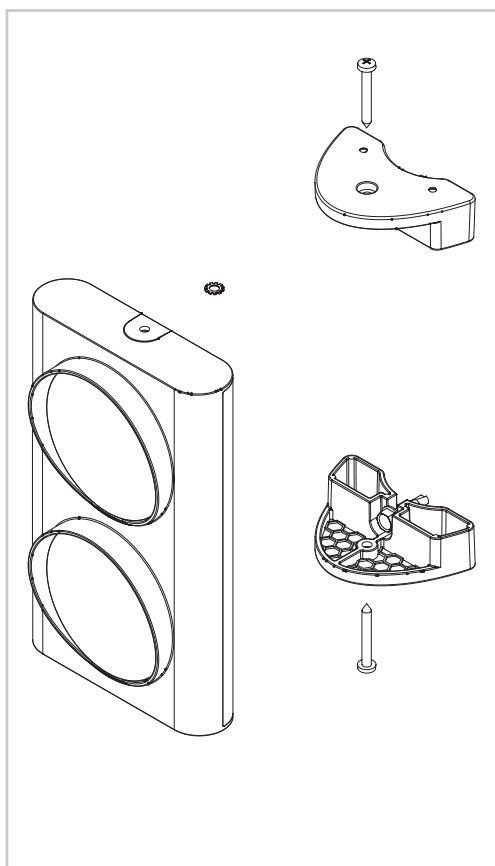

3

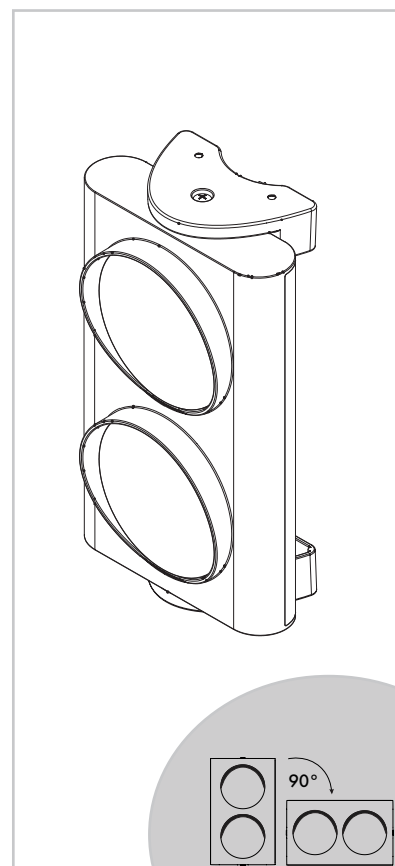

## 24V LED BOARD WIRING (AC/DC)



Warning! Electrical connections must be made without power supply.

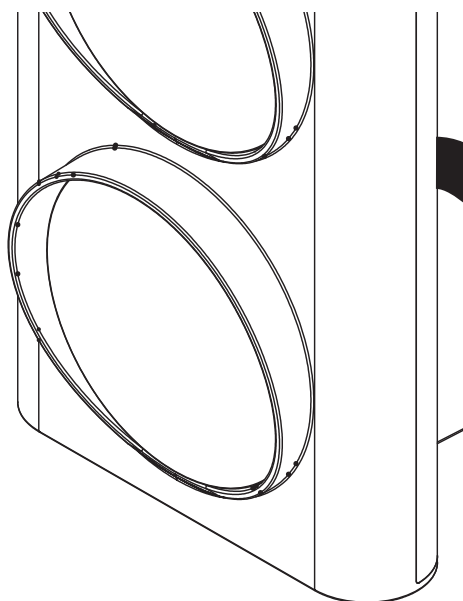

2 LIGHTS  
CABLE LENGTH  
1000 mm

GREEN +24V (AC/DC)

RED +24V (AC/DC)

COMMON -24V (AC/DC)

## LENS ROTATION

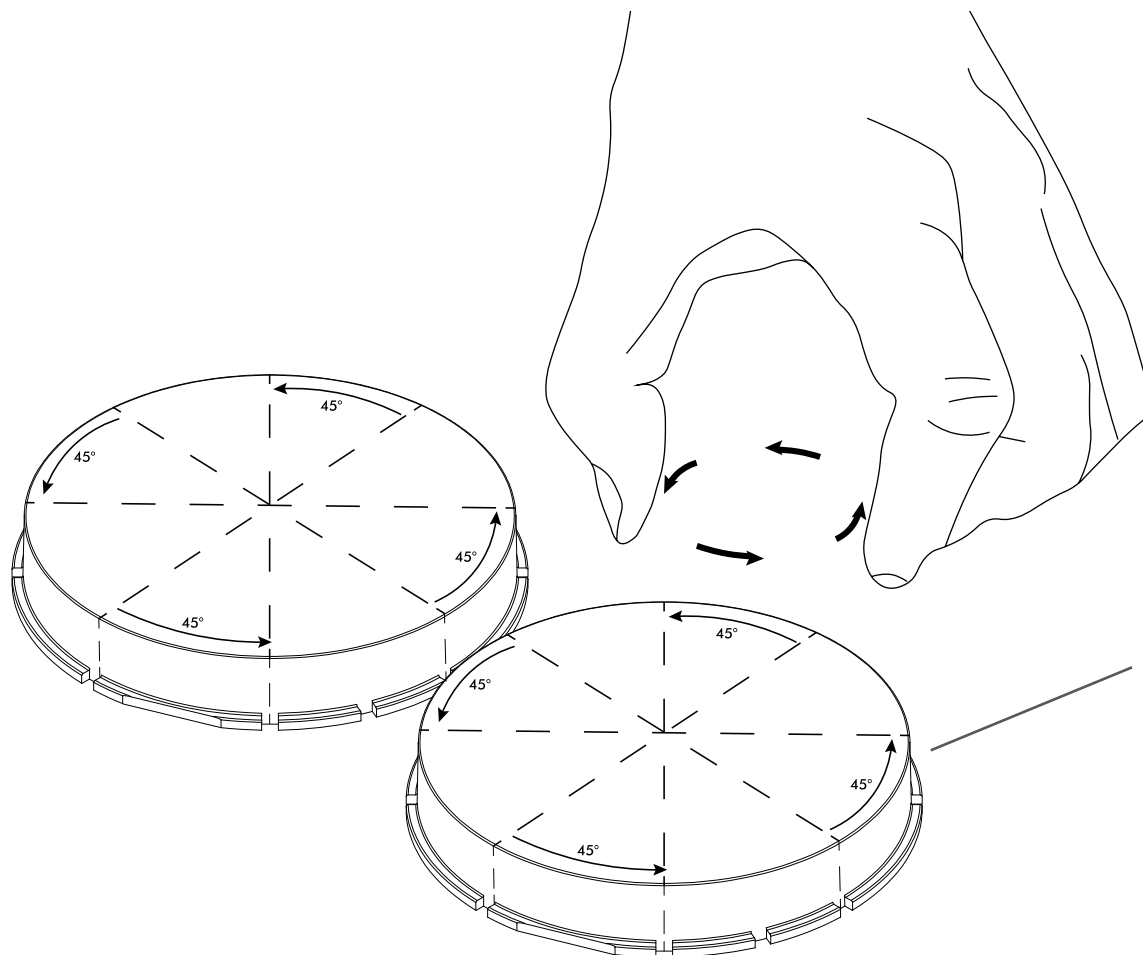

8 LENS  
ADJUSTMENT  
POSITIONS



## DISPOSAL



The packaging components, cardboard, or plastic can be recycled through separate collection. In the case of disposal of the product on the other hand need to pay much attention to components that may contain pollutants such as circuit boards, remote control batteries etc., which must be recovered or disposed of in special centres or at authorized facilities. In this case it is necessary to refer to the specific regulations in force in the place of disposal.

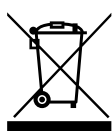

The crossed-out waste bin symbol on the appliance or on its packaging means that at the end of its useful lifespan, having to be treated separately from household waste, it must be taken to a separate collection centre for electrical and electronic equipment. Otherwise, the user can return it to the retailer at the time of purchase of a new type of equivalent appliance.

The user is responsible for providing the appliance at the end of its life to the appropriate collection facilities. The appropriate separate collection to permit the consequent recycling, treatment and environmentally compatible disposal helps prevent negative impact on the environment and human health and promotes the recycling of the materials making up the product. For MORE detailed information regarding the collection systems available, contact the local waste disposal service or the shop where the purchase was made.

EN



## SAFETY



Please read and understand this manual before using the traffic lights for the first time. This manual describes all the traffic lights main functions. The features available are related to the necessary system

- The traffic light can be used outdoors, thanks to its IP56 insulation rating
- Connect the device only to 24V ac/dc sources.
- Switch off all the devices concerned (control unit, system, accessories) before connecting or disconnecting them.
- Do not use the device in an explosive environment.
- Do not use the device near high voltage cables.
- The device or parts of it may overheat during normal operation. Do not touch the device during the operation and let it cool down before changing the printing material and before disassembly.
- Perform only the operations described in this manual. Other operations can only be performed by qualified personnel or service technicians, otherwise they will void the manufacturer's warranty.
- Unauthorised interference with electronic modules or their software may cause faults.
- Other unauthorised operations or modifications to the device may also endanger the safe operation of the device.
- The device has some warning labels to protect the user and, therefore, should not be removed.
- The traffic light is configured for a voltage between 18 and 32 V ac/dc
- Do not place the unit on an unstable surface or support.
- Do not place any object on top of the product.
- Use only the power source indicated on the specifications label.
- Perform only the operations described in this manual. Maintenance on traffic lights must only be carried out by specialised and qualified personnel. **DANGER!** Danger of electrocution **DO NOT** open the traffic light structure. Contact with the power source can cause serious injury or death.

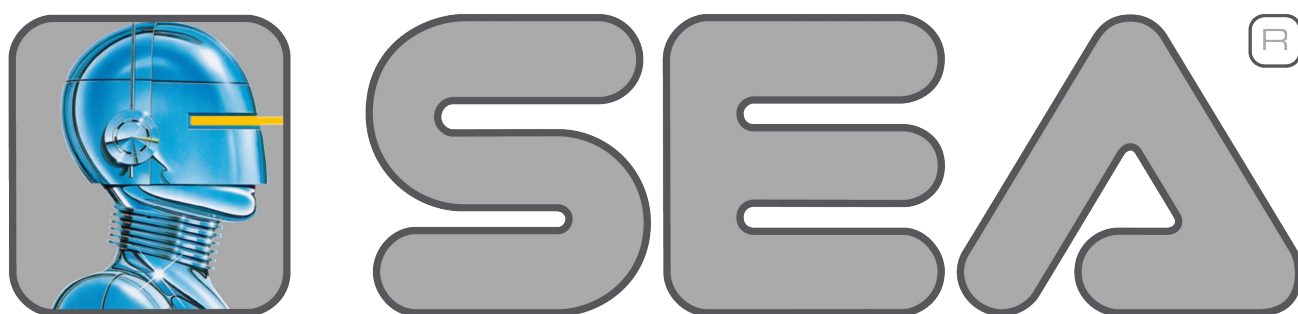

Automatic Gate Openers

**SEA S.p.A.**

Zona Industriale Sant'Atto - 64100 - Teramo - ITALY

Phone: +39 (0) 861 588 341 r.a.

<http://www.seateam.com>